



THE NATIONAL AGRICULTURAL MARKETING AND DEVELOPMENT CORPORATION

" Taking Trinidad and Tobago Foods to the World "

3 ¼ MM S.S Erin Road, Debe, Trinidad & Tobago, West Indies Tel: 647-3218/3467/3866

Fax: 647-6087 Email:contact@namdevco.com Websites: www.namdevco.com/www.namistt.com

April 30th 2026

Dear Sirs,

Re: Invitation to Tender

The National Agricultural Marketing and Development Corporation (NAMDEVCO) invites suitable contractors to submit sealed tender submissions for:

003/01/I/359 Establishment of a Central Farmers Wholesale Market – Screeding and Grading of the Processing Floor Areas at the Woodford Lodge Facility.

Tenders are to be submitted in accordance with the following:

- This Letter of Invitation
- Instructions to Tenderers
- Form of tender
- Bills of Quantities
- The Condition of Contract
- Forms of Agreement and Security
- Performance Specifications
- Tender Drawings

DESCRIPTION OF WORK

The scope of work shall be as detailed in the Bill of Quantities, Drawings and Specifications. Works shall conform to all statutory and regulatory requirements of Trinidad and Tobago and all requirements as outlined in this Invitation to Tender.

SITE VISIT

NAMDEVCO shall facilitate a **MANDATORY** site visit on **Monday 11th May, 2026, 10:30am at The NAMDEVCO Woodford Lodge- Central Farmers Wholesale Market, Chaguanas.**

SUBMISSION OF TENDER

One (1) Original and One (1) Copy and an electronic version of the written document in PDF of the Complete Tender Submission shall be submitted in separate packages marked "Original – Eligibility Document & Technical & Financial Proposal" and "Copy – Eligibility Document & Technical & Financial Proposal". Each Package shall also carry the name of the Tender:

003/01/I/359 Establishment of a Central Farmers Wholesale Market – Screeding and Grading of the Processing Floor Areas at the Woodford Lodge Facility.

Within package 1, which shall be marked “Original”, there should be two (2) envelopes. The contents of each envelope shall be as follows:

Envelope One (1)

Proof of Eligibility – Place the original of the Tenderer's Eligibility Documents in Envelope One (1), clearly labeled "Original – Eligibility Documents".

Envelope Two (2)

Technical & Financial Proposal - The Original of the Technical and Financial Proposal shall be placed in a sealed envelope clearly marked "Technical & Financial Proposal", and labeled "Original – Technical & Financial Proposal".

Package 2, which shall contain the Copies, shall be similarly prepared and labelled “Copy”, with the 2 enclosed envelopes, appropriately labelled “Copy – Eligibility Documents” and “Copy – Technical & Financial Proposal”. The Electronic version of your submission should be placed in the envelope labelled “Copy – Technical and Financial Proposal”.

Envelopes 1 & 2 in each package, shall also be labeled as follows, with the name of the Tenderer clearly shown on the envelope:

003/01/I/359 Establishment of a Central Farmers Wholesale Market – Screeding and Grading of the Processing Floor Areas at the Woodford Lodge Facility.

NAME of Tenderer:

All packages are to be deposited in a Tender Box bearing the label:

003/01/I/359 Establishment of a Central Farmers Wholesale Market – Screeding and Grading of the Processing Floor Areas at the Woodford Lodge Facility.

Located at the lobby area of NAMDEVCO's Head Office, 3 ¼ MM S.S. Erin Road, Debe, Trinidad, and shall be deposited no later than **12:00 noon (AST) on Friday 05th June 2026.**

Tenderers are asked to note that the opening in the tender box is approximately 280mm wide by 65mm high and therefore should package all documentation accordingly.

SUBMISSION OF BIDS

The Tenderer shall submit the following documents with their bid:

ELIGIBILITY AND QUALIFICATIONS REQUIREMENTS

- General Contractors possessing the requisite experience and resources to undertake the scope of works outlined in these Tender Documents, are required to provide evidence of prequalification or must apply for registration with the Office of Procurement Regulation (OPR) prior to the tender closing date. The applicable lines of business is classified under the following:
 - Procurement Depository Code: **72121103 - Commercial and Office Building Renovation and Repair Service.**
 - Procurement Depository Code: **72152509 – Floor Leveling Service.**
- Letter of Tender.
- Copy of Certificate of Incorporation and Continuance (where applicable) for Limited Liability Companies OR Copy of Certificate of Registration for Partnerships and Sole Proprietors.
- Notice of Directors or Change of Directors.
- Annual Return (current fiscal period) (for companies)
- Value Added Tax Clearance Certificate, **valid as at the deadline date for submission of proposals, or a letter of exemption from the Board of Inland Revenue.**
- Income Tax Clearance Certificate, **valid as at the deadline date for submission of proposals, or a letter of exemption from the Board of Inland Revenue**
- National Insurance Board Clearance Certificate, **valid as at the deadline date for submission of proposals, or a letter of exemption from the National Insurance Board.**
- Declaration Form.
- Any additional information the Proponent deems necessary.

Certificates issued in a name other than that used to submit the tender would result in the rejection of the tender.

BID PRICE REQUIREMENTS

- Priced Itemised Scope of Works as supplied as part of the Tender Package with company stamp.
- Completed, signed and stamped, Form of Tender as supplied as part of the Tender Package.

TENDER VALIDITY PERIOD

- Tender offer shall remain valid until the expiration of 90 days from the date of this tender.
- Completion of declaration form.

OPENING OF BIDS

The Tender Box containing the Tenders will be opened at **a date to be notified** and will be subsequently evaluated at NAMDEVCO's office.

LIMITATIONS/RESERVATIONS

NAMDEVCO reserves the right to accept or reject any or all Tenders without defraying any cost incurred by the interested party. NAMDEVCO reserves the right to cancel the present Invitation to Tender in its entirety or even partially, without defraying any cost incurred by any Applicant.

LATE SUBMISSIONS

Late submissions will **NOT** be considered under any circumstances. Any Tenders received after the deadline for submission will be returned unopened to the Tenderer. NAMDEVCO does not bind itself to accept the lowest or any tender.

PRICING

All prices shall be considered to include all costs except VAT. All prices shall be deemed to include all incidental works arising out of existing site conditions. VAT, if applicable, must be separately stated in the financial bid.

All prices and amounts shown on the Bills of Quantities, shall be expressed in Trinidad and Tobago dollars.

PAYMENT SCHEDULE

All payments shall be made in accordance with the Ministry's approved Payment Policy for Infrastructure Works. Disbursements shall be contingent upon verified progress and successful completion of the Scope of Works, ensuring effective financial control and accountability. Each payment shall be subject to verification and certification by the Employer's Representative.

Payment Milestones:

- 1. Mobilization Payment:** 10% of the contract price.
- 2. Interim Payment # 1:** 40% of contract price when 40% of Scope of Work is successfully completed, inspected and certified by the Employer's Representative.
- 3. Interim Payment # 2:** 40% of contract price when 100% of Scope of Work is successfully completed, inspected and certified by the Employer's Representative.

4. Final Payment / Retention Payment: 10% retention payment after the three (3) months defects liability period has passed with no issues flagged by the Employer's Representative.

SKILL AND EXPERIENCE OF CONTRACTOR

Tenderers responding to this invitation to tender will be deemed to have the practical skill and experience required to perform in works of a similar nature.

ENQUIRIES

All enquiries regarding submission should be directed in writing to the Procurement Officer of NAMDEVCO via email at procurement@namdevco.com .

Yours respectfully

Nirmalla Debysingh

Ms. Nirmalla Debysingh
Chief Executive Officer
NAMDEVCO

NATIONAL AGRICULTURAL MARKETING AND DEVELOPMENT CORPORATION

"Taking Trinidad and Tobago Foods to the World"

3 ¼ MM S.S Erin Road, Debe, Trinidad & Tobago, West Indies Tel: 647-3218/3467/3866
Fax: 647-6087 Email: contact@namdevco.com Websites: www.namdevco.com/www.namistt.com

INSTRUCTIONS TO TENDERERS

1 Submission of Tender

Tenders are invited for the execution of works as outlined in the attached Tender Documents for the National Agricultural Marketing and Development Corporation (NAMDEVCO).

The following documents are contained herein:

- a) Instructions to Tenderers
- b) Form of Tender
- c) Appendix to General Conditions of Contract
- d) General Description of Works
- e) Bills of Quantities
- f) Technical Specifications
- g) Drawings (which shall be taken to include Sketches & Pictures)

These documents comprise the Tender Documents.

Every Tender shall be made on the form supplied without any alteration therein. One complete and unaltered copy of the Tender Documents, containing the Form of Tender, issued addenda if any, and the priced Bill of Quantities expressed in Trinidad and Tobago dollars and shall be returned with the tender.

2 Skill and Experience of Contractor

Tenderers are expected to have practical skill and experience acquired as a Contractor in the construction of works of a similar or analogous nature and be equipped with an ample quantity of suitable labour, plant and appliances, financial capability and be in every respect fully competent to undertake the execution of the Contract. This presumption shall in no way relieve the Tenderer of any obligation in respect of his Tender.

3 Discrepancies in Specifications or Drawings

Anything mentioned in the Specifications or the Bills of Quantities, but not shown on the Drawings, or shown on the Drawings, but not mentioned in the Specifications or the Bills of Quantities shall be of like effect as if shown or mentioned in both. In case of ambiguity between the Drawings and Specifications, the Specifications shall govern. Any ambiguity found in the Drawings or Specifications shall be called to the attention of the Employer prior to tendering. Ambiguities will be clarified by the Employer by Addenda prior to accepting tenders, and one (1) copy of each Addendum shall be executed by an officer of the Tenderer and submitted with the Tender. No consideration will be given to any claim by any Tenderer that an ambiguity or question was settled verbally prior to submitting his Tender.

In general, no answer will be given to prospective Tenderers in reply to an oral question if the question involves an interpretation of the intended meaning of the Drawings or Tender Documents or the equality or use of products or methods other than those definitely designated or described on the Drawings or in the Specifications. All information given to Tenderers other than by means of the Drawings and Tender Documents or by Addenda, as described below, if given informally, shall not be used as the basis of a claim. To receive consideration, such questions shall be submitted in writing to the Engineer so as to be received at least three (3) days before the established date for receipt of bids. If the question involves the quality of substitution of products or methods, it must be accompanied by drawings, Specifications, or other data in sufficient detail to enable the Employer to determine the equality or suitability of the product or method. In general, the Engineer will neither approve nor disapprove particular products or methods prior to the opening of the Tenders; such products or methods will be considered when offered by the Contractor for incorporation into the Works.

Decisions rendered by the Employer in response to questions received as above-provided will be arranged as Addenda and shall become a part of the Contract.

The Contractor agrees to use the products and methods designated or described in the Specifications or as amended by the Addenda.

4 Obligation of the Tenderer

At the time of the opening of the Tenders, each Tenderer will be presumed to have inspected the Site and to have read and to be thoroughly familiar with the Drawings and Tender Documents (including all Addenda), and satisfied himself as to the nature, extent and practicability of the Works and all other points which can in any way affect the prices inserted in the Bills of Quantities and Appendices. The failure or omission of any Tenderer to examine any form, instrument, or document shall in no way relieve any Tenderer from any obligation in respect of his Tender.

5 Accuracy and Purpose of Bills of Quantities

The numbers, quantities and measurements (if these are) given in the Bills of Quantities are approximate only and their accuracy/inaccuracy shall in no way affect the validity of the Tender or any Contract based thereon.

The attention of the Contractor is drawn to the preamble to the Bills of Quantities.

The Tenderer shall visit the site and verify:

- The location of the work area.
- Access to the works areas and restrictions
- Work, storage and parking areas
- Any other features which may affect their tender price or the performance of the contractor.

6 Discrepancies in Tender

Significant arithmetical errors or obvious errors in pricing discovered in the Tenderers priced Bills of Quantities will be dealt with as described herein.

The Tenderer will be informed of the amount and nature of the errors and if he wishes to stand by his tender or to withdraw his tender.

If the Tenderer elects to stand by his tender for the purpose of administering the contract and for interim payments and settlement of accounts, an endorsement, signed by both parties to the contract, will be added to the priced Bills of Quantities indicating that all rates or prices (excluding preliminary items, prime cost and provisional sums) inserted therein by the Tenderer are to be considered as reduced or increased in the same proportion as the corrected total or priced items exceeds or falls short of the original total of such items.

Alternatively, by agreement with the Tenderer, the total net error shall be added to or deducted from the total shown against Preliminaries, so that the tendered sum remained the same, and an endorsement signed by both parties to the contract will be added to the priced Bills of Quantities.

Where errors are discovered after acceptance of the tender, the errors will be adjusted by either of the foregoing methods as the Tenderer would be deemed to have stood by his tender.

7 Pricing

All prices shall be considered to include all duty, tax, transportation, and other costs, unless otherwise stated. All prices shall be deemed to include all incidental works arising out of existing site conditions.

All prices and amounts shown on the Tender, the Bills of Quantities, and other parts of the Contract shall be expressed in Trinidad and Tobago dollars.

8 Submission of Documents

The Tenderer shall submit the following documents with their tender, the contents of which shall be used to evaluate award:

ELIGIBILITY AND QUALIFICATIONS REQUIREMENTS

- General Contractors possessing the requisite experience and resources to undertake the scope of works outlined in these Tender Documents, are required to provide evidence of prequalification or must apply for registration with the Office of Procurement Regulation (OPR) prior to the tender closing date. The applicable lines of business is classified under the following:
 - Procurement Depository Code: **72121103 - Commercial and Office Building Renovation and Repair Service.**
 - Procurement Depository Code: **72152509 – Floor Leveling Service.**
- Letter of Tender.
- Copy of Certificate of Incorporation and Continuance (where applicable) for Limited Liability Companies OR Copy of Certificate of Registration for Partnerships and Sole Proprietors.
- Notice of Directors or Change of Directors.
- Annual Return (current fiscal period) (for companies)
- Value Added Tax Clearance Certificate, **valid as at the deadline date for submission of proposals, or a letter of exemption from the Board of Inland Revenue.**

- Income Tax Clearance Certificate, **valid as at the deadline date for submission of proposals, or a letter of exemption from the Board of Inland Revenue**
- National Insurance Board Clearance Certificate, **valid as at the deadline date for submission of proposals, or a letter of exemption from the National Insurance Board.**
- Declaration Form.
- Any additional information the Proponent deems necessary.

Certificates issued in a name other than that used to submit the tender would result in the rejection of the tender.

A) Technical Requirements

a. Company Profile, Organizational Structure of Project Team and Technical Competence.

- Bidder must provide a company profile describing the company's core business in the last 5 years demonstrating their experience in undertaking projects or providing services similar to those specified in the requirements of this tender document.
- A brief description of the Bidder's Project Team including the organizational structure of the Project Team.
- Name and CV's of all persons mentioned on the project team who would be responsible for the implementation of project.

b. Experience of similar nature.

- Bidder to provide a list of jobs completed over the past five (5) years comparable to the scope requirements as well as similar in contract amount. This list should include; the year that the job was executed, the client that the job was performed for, the value of the job and what about the job was similar to these works.
- Bidder to provide at least two (2) references (written evidence) of satisfactory performance in works in a similar nature. These references should also include name of organization, point of contact including email and valid telephone contact, address and position.

c. List of Equipment.

- Bidders are required to submit a comprehensive inventory of the machinery, tools, and vehicles they intend to use for the execution of the work. Bidders should provide ample proof of ownership such as certified copies etc. In cases where equipment is leased, bidders must provide a letter confirming the lease arrangement and, where applicable, proof of ownership from the leasing company.

d. Method Statement.

- Detailed approach for execution of works (i.e. systematic process from mobilization, procurement, delivery, construction works and project close off.)
- Supervision and monitoring strategy.
- Quality management, HSE concerns, risks and mitigation strategies relative to all equipment and materials.

e. Implementation Schedule.

- Works Program with major / critical activities and assigned dates that is, the works program should demonstrate a logical sequence of tasks, with appropriate timeframes allocated to each phase of the project.

e. Financial Capability.

- Each tenderer is also required to submit the following:
 - I. A statement advising whether there is any litigation affecting completion or operation of any project pending against the proponent, and if there is such litigation, name(s) of court(s) and incumbent(s).
 - II. A statement advising whether or not the proponent and/or any Joint Venture participants or any of their principals, officers, or directors have been involved in any bankruptcy proceedings in the past seven (7) years.
 - III. A letter from a financial institution attesting to the financial capability of the firm.
 - IV. Audited Financial Statement (last three years).
 - V. Tenders that are not responsive to the requirements of the tender documents shall be rejected.

B) Financial Proposal

The Financial Proposal shall comprise:

- a) The Completed Form of Tender. (Form of Tender **MUST** be completed, duly signed and stamped) **(MUST PASS to be eligible for Evaluation)**
- b) The Completed priced Bill of Quantities **(with company stamp)**

9 Evaluation and Award

Eligibility Requirement – Must Pass

Tenderers Eligible for award must score an overall mark of at least 70%, and must attain a minimum of 50% on each item below, using the marking criteria below:

<u>Evaluation Criteria</u>	<u>Max Score</u>
Technical Requirements	
a. Company Profile, Organizational Structure of Project Team and Technical Competence. <ul style="list-style-type: none">• Bidder must provide a company profile describing the company’s core business in the last 5 years demonstrating their experience in undertaking projects or providing services similar to those specified in the requirements of this tender document. (5 marks)• A brief description of the Bidder’s Project Team including the organizational structure of the Project Team. (5 marks)	15

<ul style="list-style-type: none"> Name and CV's of all persons mentioned on the project team who would be responsible for the implementation of project. (5 marks) 	
<p>b. Experience of similar nature</p> <ul style="list-style-type: none"> Bidder to provide a list of jobs completed over the past five (5) years comparable to the scope requirements as well as similar in contract amount. This list should include; the year that the job was executed, the client that the job was performed for, the value of the job and what about the job was similar to these works. (20marks). Bidder to provide at least two (2) references (written evidence) of satisfactory performance in works in a similar nature. These references should also include name of organization, point of contact including email and valid telephone contact, address and position. (5marks) 	25
<p>c. List of Equipment</p> <ul style="list-style-type: none"> Bidders are required to submit a comprehensive inventory of the machinery, tools, and vehicles they intend to use for the execution of the work. Bidders should provide ample proof of ownership such as certified copies etc. In cases where equipment is leased, bidders must provide a letter confirming the lease arrangement and, where applicable, proof of ownership from the leasing company. (5 marks) 	5
<p>d. Method Statement</p> <ul style="list-style-type: none"> Detailed approach for execution of works (i.e. systematic process from mobilization, procurement, delivery, construction works and project close off.) (20 marks) Supervision and monitoring strategy. (4 marks) Quality management, HSE concerns, risks and mitigation strategies relative to all equipment and materials. (6 marks) 	30
<p>e. Implementation Schedule</p> <ul style="list-style-type: none"> Works Program with major / critical activities and assigned dates that is, the works program should demonstrate a logical sequence of tasks, with appropriate timeframes allocated to each phase of the project. (10marks) 	10

f. Financial Capability	15
<ul style="list-style-type: none"> • Letter from Financial Institution. (4 marks) • Statement of bankruptcy and statement of litigation. (5 marks) • Audited Financial Statement (last three years). (6marks) 	
<i>TOTAL Technical Evaluation (T)</i>	
	<i>100</i>

Financial Evaluation

- a) The financial bids of only the Tenderers, who have satisfied all the requirements as outlined in the above Eligibility Requirements and Technical Evaluation will be considered for further evaluation.
- b) Contract will normally be awarded to the lowest responsive bidder subject to abnormally low bid protocols.

NOTE: NAMDEVCO does not bind itself to the lowest or any offer.

10 Return of Tenders

Tenders shall be addressed as indicated in the Invitation to Tender.

11 Payment in Local Currency

Payment to the Contractor shall be made in Trinidad and Tobago dollars.

DECLARATION FORM

A. LITIGATION

1. Have you ever been convicted of any criminal offence in any jurisdiction?
 Yes No
2. Have any of the director(s) ever had a professional license suspended or revoked?
 Yes No
3. Has your organisation ever been the subject of any petition for bankruptcy?
 Yes No
4. Does your organisation have any judgments against you?
 Yes No
5. Does your organisation have any pending civil litigation matters?
 Yes No
6. Does your organisation have any pending criminal matters?
 Yes No
7. Has your organisation, or any organisation over which you have had control ever been the subject of any inquiry or investigation?
 Yes No

If you checked **Yes** to any of the above questions, kindly provide the key facts and decisions, including dates, relating to these matters on a separate page to be annexed to this document.

B. STATUTORY COMPLIANCE

1. Is your organisation in compliance with the **OSH Act 2004** (as amended) in the form of OSH requirement applicable to your organisation? Kindly provide details of the compliance with the most recent supporting documents.
 Yes No Not applicable

If no or not applicable is selected, please provide details:

2. Is your organisation in compliance with the **Minimum Wages Act, Chap 88:04** (as amended)?
 Yes No Not applicable

If no or not applicable is selected, please provide details:

I/We.....make this declaration conscientiously believing the same to be true, and I/We am/are aware that if there is any statement in this declaration which is false in fact, which I/We know or believe to be false or do not believe to be true, I/We may be disqualified from the Tendering process or if awarded the Tender, the contract will be immediately terminated.

.....
Declarant Name

.....
Declarant Signature

.....
Date

Position:

Company Seal:



TENDER DOCUMENT

FOR

FLOOR SCREEDING

AT THE

CHAGUANAS FARMERS' MARKET

AT

WOODFORD LODGE, CHAGUANAS.

Employer

The National Agricultural Marketing
Development Corporation
(NAMDEVCO)
S.S. Erin Road, Debe.

Dated: February 2026

TABLE OF CONTENTS

Section 1	Agreement
Section 2	General Conditions of Contract
Section 3	Letter of Tender
Section 4	Specifications
Section 5	Preliminaries
Section 6	Bill of Quantities
Section 7	Summary
Section 8	Drawings

Section 1

Form of Agreement

**FLOOR SCREED AT THE CHAGUANAS FARMERS' MARKET –
WOODFORD LODGE, CHAGUANAS
FORM OF AGREEMENT**

THIS CONTRACT is signed on _____

Employer: _____

Contractor: _____

IT IS AGREED AS FOLLOWS

1. The Employer requires an in-situ screeded floor (“the Works”) to the existing warehouse building of the Chaguanas Farmers’ Market located at Woodford Lodge, Chaguanas.
2. The Contractor possesses all necessary qualifications and licenses to enable it to carry out the Works in Trinidad and Tobago.
3. The Contractor agrees to carry out and complete the Works subject to the terms and conditions stipulated in the Conditions of Contract and the Scope of Works to a first-class international standard.
4. The Contractor shall go through the relevant application and submission approval procedures with the appropriate authorities and bureaus and obtain all necessary approvals for the Works provided by The Contractor under the Contract.

5. **Contract Sum**

This Contract is a Lump Sum Contract in the amount of _____

_____ (Vat Inclusive)

6. **Payment Terms**

Mobilization Payment: 10% of contract price.

Interim Payment# 1: 40% of contract price when 40% of Scope of Works is satisfactorily completed.

Interim Payment # 2: 40% of contract price when 100% of Scope of Works is satisfactorily completed.

Retention Amount: 10% - 3 month Retention

**FLOOR SCREED AT THE CHAGUANAS FARMERS' MARKET –
WOODFORD LODGE, CHAGUANAS
FORM OF AGREEMENT**

7. **Completion Time**

The project will be completed in _____ calendar days.

8. **Governing Law**

This Contract shall be governed by the Laws of the Republic of Trinidad and Tobago.

9. **Arbitration**

The Employer or Contractor may refer a matter to one sole Arbitrator to be mutually appointed by both parties or the President of the Association of Professional Engineers of Trinidad and Tobago (APETI) or his nominee, in accordance with the “UNCITRAL Rules” in effect at the time of the arbitration, if:

- (1) The dispute or difference has not been resolved within twenty-one days of the commencement of negotiation;
- (2) No meeting has taken place within twenty-one days of the date of the written request for negotiation referred to in clause 11.1 of the Conditions of Contract of Appendix 1.

9.1 The Arbitration tribunal shall, without prejudice to the generality of its powers, have power to:

- (1) Direct such measurements and/or valuations as may in its opinion be desirable in order to determine the rights of the Employer and Contractor;
- (2) Ascertain and award any sum which ought to have been the subject of or included in any certificate, instruction, opinion, decision, requirement or notice;
- (3) Determine all matters in dispute that shall be submitted to him in the same manner as if no such certificate, instruction, opinion, decision, requirement or notice had been given.

9.2 The arbitration award shall be final and binding on the Employer and the Contractor.

10. Each clause in this Contract is independently valid. Any clause’s invalidity or non-enforcement should not affect other clauses’ validity and enforcement.

11. Words and expressions defined in any document included in Appendix 1 or Appendix 2 or any other documents referred to in this Contract shall, unless re-defined herein or the context otherwise requires, have the same meanings when used herein.

12. The Contract will be signed in English.

13. The Contract has 4 original sets; the Employer and the Contractor shall take 2 sets respectively. All have same legal effect.

14. The Contract becomes effective after being signed and stamped by each party’s authorized representative. The Contract will be automatically void only after the Employer and the Contractor’s rights and duties come to end.

**FLOOR SCREED AT THE CHAGUANAS FARMERS' MARKET –
WOODFORD LODGE, CHAGUANAS
FORM OF AGREEMENT**

EXECUTED by the parties on the date first written above.

SIGNED BY.....

SIGNED BY.....

In the capacity of:

In the capacity of:.....

Stamp:.....

Stamp:.....

Date:.....

Date:.....

for and on behalf of the Employer in the
presence of: -

for and on behalf of the Contractor in the
presence of: -

Witness:.....

Witness:.....

Name:.....

Name:.....

Address:.....

Address:.....

Date:.....

Date:.....

Section 2

Conditions of Contract

**FLOOR SCREED AT THE CHAGUANAS FARMERS' MARKET –
WOODFORD LODGE, CHAGUANAS
CONDITIONS OF CONTRACT**

1.0 Documents, Obligations and Duties

1.1 Contract Documents

1.1.1 The Contract Documents are comprised of:

- a) Form of Agreement
- b) Conditions of Contract
- c) Letter of Acceptance
- d) Letter of Tender
- e) Scope of Works
- f) Design Drawings
- g) Bill of Quantities

1.1.2 All documents in the Contract Documents shall be taken as mutually explanatory of one another. If there is any inconsistency, the priority of the documents shall be the same as the listing in clause 1.1.1 above

1.2 Definitions

1.2.1 “Employer” — shall refer to _____

1.2.2 “Works” — shall refer to the construction and completion of the floor screed to the Chaguanas Farmers’ Market, Woodford Lodge, Chaguanas for the Employer as stipulated in Scope of Works to which these Conditions belong

1.2.3 “Employer’s Representative” — shall refer to _____

**FLOOR SCREED AT THE CHAGUANAS FARMERS' MARKET –
WOODFORD LODGE, CHAGUANAS
CONDITIONS OF CONTRACT**

1.0 Documents, Obligations and Duties (Cont'd)

1.2 Definitions (Cont'd)

1.2.5 "Site" — shall refer to the premises of the Chaguanas Farmers' Market, Woodford Lodge, Chaguanas, to, on, under, in, or through which the Works is to be executed and any other areas designated as storage or work areas in connection with the execution of the Works.

1.2.6 "Contractor" — shall refer to: _____

1.3 Contractor's Obligations

The Contractor shall in accordance with the Contract Documents carry out and complete the Works with due care and diligence and in accordance with the highest professional tradesman like standard acceptable to the Employer.

The Contractor shall provide all that is necessary for the proper execution of the Works and for the performance of his obligations under the Contract.

The Contractor has the responsibility to fully perform the obligations under this Contract.

**FLOOR SCREED AT THE CHAGUANAS FARMERS' MARKET –
WOODFORD LODGE, CHAGUANAS
CONDITIONS OF CONTRACT**

2.0 Commencement and Completion

2.1 Commencement

The Work under this Contract shall be commenced on:

2.2 Practical Completion

Practical Completion shall be achieved when all inspections, testing, commissioning, approvals and acceptance required to be made/issued by the Employer in relation to the Works completed have all been done, made or issued and acceptance of the Works have been issued to the Contractor in writing.

Where any periods of days are mentioned in these documents, they shall be taken to mean Gregorian calendar days inclusive of all holidays, Saturdays and Sundays, days of inclement weather and special holidays announced by the local Government.

2.3 Warranty

The contractor shall make good at its own cost within a reasonable period of time any quality defects that appear and are notified within 3 months of practical completion. The warranty excludes damage caused not due to quality defects in material or workmanship, and due to the Employer and Third Party's improper use or force majeure. The scope of warranty is limited to the parts provided, installed or constructed by the Contractor, not including the existing building provisions and replacement of expendables.

2.4 Penalty

If the Contractor does not achieve Practical Completion by the Completion Date then The Employer has the right to require the payment of a penalty of \$1,000.00 per day until the Contractor achieve a Practical Completion. This sum shall be deducted from the Contract Lump Sum due to the Contractor.

**FLOOR SCREED AT THE CHAGUANAS FARMERS' MARKET –
WOODFORD LODGE, CHAGUANAS
CONDITIONS OF CONTRACT**

3.0 Control of the Works

3.1 Assignment

The Contractor shall not, without the prior written consent of the Employer, assign the whole or any portion of this Contract.

3.2 Sub-Letting

3.2.1 The Contractor shall, subject to the prior written approval of the Employer, be permitted to appoint sub-contractors to execute any part of the Works.

3.2.2 The Contractor shall indemnify, defend, and hold the Employer harmless against any damage, liability, claim or loss arising from any breach of contract, repudiation, default or failure on the part of any sub-contractor and shall make good any damage or loss suffered by the Employer.

3.2.3 The Contractor shall ensure that it shall be a condition in any sub-contract that the sub-contract shall terminate immediately upon the termination (for any reason) of the Contractor's service under this Contract.

Notwithstanding the appointment of any sub-contractor, the Contractor shall be solely responsible for the completion of the Works in accordance with the terms and conditions hereof.

3.3 Variations

3.3.1 The Employer may issue instructions requiring a Variation and he may confirm in writing any Variation made by the Contractor.

3.3.2 The term "Variation" means alteration of the scope, design, quality or quantity of the Works as described by the Contract Documents.

3.3.3 The value of any Variation shall be ascertained promptly on a fair and reasonable basis using, where relevant, unit rates/prices in the Contract Documents or mutual agreement.

**FLOOR SCREED AT THE CHAGUANAS FARMERS' MARKET –
WOODFORD LODGE, CHAGUANAS
CONDITIONS OF CONTRACT**

3.0 Control of the Works (Cont'd)

3.3 Variations (Cont'd)

3.3.4 The Contractor may submit to the Employer or the Employer's Representative a written proposal which (in the Contractor's opinion) will (1) accelerate completion, (ii) reduce the cost of executing the Works or (iii) otherwise benefit the Employer. Any such proposal must be approved by the Employer or the Employer's Representative in writing before execution by the Contractor.

3.3.5 If variations require additional cost, the Employer shall confirm the written variation order ("VO") provided by the Contractor before the Contractor carries out the instruction or variation. If any such instruction or variation is likely to result in any delay to the completion date, the Contractor shall within three days of the issuance of the relevant instruction or variation, apply to the Employer in writing for an extension of time which shall be granted to the extent that the requested extension is fair and reasonable. All VO's should be fully paid after Practical Completion.

3.4 Coordination

The Contractor shall closely liaise with any suppliers and contractors directly engaged by the Employer.

3.5 _____ is assigned by the Employer as Superintendent to supervise the Works and give instruction (other than in respect of VO) on behalf of the Employer.

**FLOOR SCREED AT THE CHAGUANAS FARMERS' MARKET –
WOODFORD LODGE, CHAGUANAS
CONDITIONS OF CONTRACT**

3.6 Inspection and Acceptance

The quality assessment acceptance and construction standards are based on the construction drawings, specifications, design variations. Materials and workmanship are to be of the best quality of their respective kinds, and those for which there is a British Standard or Code of Practice are to conform thereto unless otherwise stated. Workmanship is to conform to sound building practice unless described or shown.

The Contractor shall inform the Employer or the Employer's Representative to inspect and accept the work upon completion. The Employer or the Employer's Representative will organize inspection and acceptance and handle the formalities for the inspection and acceptance as well as the handover within 3 days after the receipt of the notice of inspection and acceptance.

If the inspection is not acceptable due to Contractor's reason, the cost for the rectification will be borne by Contractor and the project schedule remains unchanged.

4.0 Certifications and Payments

4.1 Payment shall be made by Employer to the Contractor according to the Contract

4.2 Fixed Price

The Contract Sum shall be in lump sum. Unless otherwise provided herein, no account shall be taken in any payment to the Contractor of any change in the cost to the Contractor of the labour, materials, plant and other resources employed in carrying out the Works.

4.3 Schedule of Rates

The Schedule of Rates shall be deemed to be the Contractor's own breakdown and shall not be subject to re-measurement or adjustment, including adjustment of any error that may be detected. The descriptions and quantities shall be for reference only and shall not form part of the Contract nor be taken for defining the scope of Works. The unit rates shall be fixed rates and shall be used for valuation of Variations.

**FLOOR SCREED AT THE CHAGUANAS FARMERS' MARKET –
WOODFORD LODGE, CHAGUANAS
CONDITIONS OF CONTRACT**

5.0 Statutory Obligations, Notices, Fees and Charges

5.1 Fees and Charges

5.1.1 The Contractor shall pay at its sole cost any fees and charges legally demandable and shall indemnify the Employer against liability in respect of any such fees and charges.

5.2 Statutory Requirements

5.2.1 The Contractor shall comply with and give all notices required by any statutory requirement.

5.2.2 If the Contractor finds any discrepancy between any statutory requirement and the Contract Documents, the Contractor shall immediately give to the Employer notice specifying the discrepancy.

5.2.3 If the discrepancy is due to any change in any statutory requirement that came into effect after the date for close of bidding for the Works, then the Contractor shall be entitled to a Variation under the Contract for costs associated with satisfying the new requirements.

6.0 Injury, Damage and Insurance

6.1 Injury to or Death of Persons

6.1.1 The Contractor shall be liable for and shall indemnify, defend and hold the Employer harmless against any expense, liability, loss, claim or proceedings arising under any law in respect of personal injury to or death of any person, arising out of or caused by the carrying out of the Works, except to the extent that the same is due to any wilful misconduct or gross neglect of the Employer or of any person for whom the Employer is responsible.

6.1.2 Without prejudice to his liability to indemnify the Employer, the Contractor shall at its sole cost take out and maintain insurance to comply with the statutory requirements and to cover any other liability for personal injury or death as is necessary. The Contractor shall ensure that all its sub-contractors shall take out and maintain their own insurance to comply with the statutory requirements.

**FLOOR SCREED AT THE CHAGUANAS FARMERS' MARKET –
WOODFORD LODGE, CHAGUANAS
CONDITIONS OF CONTRACT**

6.0 Injury, Damage and Insurance (Cont'd)

6.2 Injury or Damage to Property

6.2.1 The Contractor shall be liable for and shall indemnify, defend and hold the Employer harmless against any expense, liability, loss, claim or proceedings in respect of any damage to any property real or personal arising out of or caused by the carrying out of the Works, except to the extent that the same is due to any gross negligence, breach of statutory duty, omission or default of the Employer, his servants or agents.

7.0 Design Responsibility

7.1 Design Responsibility

7.1.1 In preparing the design and complying with the obligations under Clause 7.1.1, the Contractor shall, comply in all respects with the Employer's procedures to review the design.

7.1.2 In any event, the Contractor shall comply with all local Government codes, standards and regulations.

8.0 Termination

8.1 Termination by Employer

8.1.1 The Employer may (but not unreasonably or vexatiously) terminate this Contract if the Contractor:

8.1.1.1 Wholly suspends, without reasonable cause, the carrying out of the Works before completion;

8.1.1.2 Fails to proceed regularly and diligently with the Works for a period of fourteen continuous days.

8.1.1.3 Becomes insolvent or bankrupt or is likely to have a petition presented for a winding up or bankruptcy order;

8.1.1.4 Shall have offered or given or agreed to give to any person any gift or consideration of any kind in connection with the award or performance of this Contract or if the Contractor shall have committed any offence under the law of corruption;

**FLOOR SCREED AT THE CHAGUANAS FARMERS' MARKET –
WOODFORD LODGE, CHAGUANAS
CONDITIONS OF CONTRACT**

8.0 Termination (Cont'd)

8.1 Termination by Employer (cont'd)

8.1.1 The Employer may (but not unreasonably or vexatiously) terminate this Contract if the Contractor: (cont'd)

8.1.1.5 Shall have been found to have any illegal activity in connection with the performance of the Works or otherwise on Site.

8.1.1.6 The Employer has the right to terminate contract if work not complete 21 days after completion date due to the Contractor's reason.

8.1.2 In the event of the Employer terminating the Contractor under clause 8.1.1, the Contractor shall immediately give up possession of the Site of the Works. The Employer shall carry out a valuation of works completed and materials delivered (not including any cost of demobilization) at the date of termination. The Contractor shall be entitled to be present at such valuation. The Employer shall not be bound to make any further payment to the Contractor until after completion of the Works. The Employer may engage and pay other persons to complete the Works and shall be entitled to use all materials and goods brought onto the Site by the Contractor for the purposes of incorporation in the Works. The costs for such engagement of third parties to complete the Works shall be deducted from the payment due to the Contractor.

8.1.3 The Contractor shall then be entitled to payment of such amount (if any) as would have been payable to the Contractor upon completion by him of the Works. If the amount exceeds the amount that would have been payable to the Contractor upon completion by him of the Works, the excess shall be recoverable by the Employer from the Contractor as a debt.

8.1.4 The rights set out in clause 8.1 shall be without prejudice to any other rights or remedies the Employer may possess

**FLOOR SCREED AT THE CHAGUANAS FARMERS' MARKET –
WOODFORD LODGE, CHAGUANAS
CONDITIONS OF CONTRACT**

8.0 Termination (Cont'd)

8.2 Termination by Contractor

8.2.1 The Contractor may (but not unreasonably or vexatiously) terminate this Contract if the Employer:

8.2.1.1 Does not pay the amount undisputed and properly due to the Contractor on any Certificate within fourteen days from the issue of that invoice;

8.2.1.2 Or any person for whom he is responsible interferes with or obstructs the carrying out of the Works or fails to make the Site available for the Contractor on the commencement date or 7 continuous days afterwards;

8.2.1.3 Prevents the carrying out of the Works for a continuous period of at least one month;

8.2.1.4 Becomes insolvent or bankrupt or is likely to have a petition presented for a winding up or bankruptcy order.

Provided that the Contractor shall not terminate this Contract under this clause unless the Employer has continued the default as referred to in clauses 8.2.1.1 to 8.2.1.3 for seven days after receipt of a notice from the Contractor specifying such default.

8.2.2 In the event of the Contractor terminate the Contract under clause 9.2.1 the Employer shall pay to the Contractor, after taking into account amounts previously paid, such sum as shall be fair and reasonable for the value of works begun and executed, materials on Site and the removal of all temporary buildings, plant, tools and equipment. The right of termination shall be without prejudice to any other rights or remedies which the Contractor may possess.

**FLOOR SCREED AT THE CHAGUANAS FARMERS' MARKET –
WOODFORD LODGE, CHAGUANAS
CONDITIONS OF CONTRACT**

9.0 Loss and Expense

9.1 Disturbance to the Progress of the Works

9.1.1 The Contractor shall notify the Employer if, for reasons beyond the Contractor's control, the Contractor has incurred any direct loss and/or expense, for which he would not be reimbursed by a payment made under any other provision of these Conditions by reason of the progress of the Works being materially affected by:

9.1.1.1 The Contractor not having received in due time necessary instructions, drawings, details or levels from the Employer

9.1.1.2 Any Variation ordered in accordance with clause 3.3; or

9.1.1.3 The opening up for inspection of any work covered up or the testing of any materials or goods, which is not required under the specifications for the Works or relevant regulations, unless the inspection or test showed that the Works, materials or goods were not in accordance with the Contract; or

9.1.1.4 Delay on the part of suppliers, contractors or others engaged by the Employer in supplying goods or carrying out works not forming part of the Works or;

9.1.1.5 Employer's instructions issued in regard to the postponement of any works forming part of the Works,

Then the Contractor shall submit his claims together with detailed substantiation and the Employer shall promptly review the loss and expense incurred, if any

**FLOOR SCREED AT THE CHAGUANAS FARMERS' MARKET –
WOODFORD LODGE, CHAGUANAS
CONDITIONS OF CONTRACT**

10.0 Settlement of Disputes

10.1 Negotiation

The Employer and the Contractor shall attempt in good faith to resolve promptly through negotiation, any dispute or difference arising out of or in relation to the Contract. Within ten days after execution of the Contract, the Employer and the Contractor shall each designate a senior person preferably not involved in the day-to-day administration of the Contract, with authority to settle disputes. If a dispute or difference should arise, the senior persons shall meet at least once and attempt in good faith to resolve the dispute or difference. For such purpose any senior person may request in writing to meet the other, within ten days of the date of the request, at a mutually agreed time and place. If the senior persons are unable to resolve the dispute or difference either within twenty-one days of the date of the first meeting or if no meeting has taken place within twenty-one days of the date of the written request, then any one of the Employer or the Contractor may refer the matter to arbitration in accordance with Arbitration clause in this Contract.

10.2 Time Periods

10.2.1 Any time period referred to in clauses 10.1 can be extended by written agreement between the Employer and the Contractor.

10.2.2 A reference under clauses 10.1 above may be made during the currency of the Contract. None of the Employer or the Contractor shall be released from continuing performance of his obligations under this Contract by reason of such reference.

11.0 Workmen Living on Site - Not Allowed

The Contractor shall not allow the workmen, to cook and live on the Site at any time throughout the Contract.

12.0 Quality of Materials and Workmanship

The whole of the materials, goods and workmanship shall be consistent with the highest professional tradesman like standard. All Works shall be in compliance with the Employer's Requirements and any requirement of the local statutory standards and regulations whichever is higher in standard.

**FLOOR SCREED AT THE CHAGUANAS FARMERS' MARKET –
WOODFORD LODGE, CHAGUANAS
CONDITIONS OF CONTRACT**

13.0 Force Majeure

- 13.1 If any circumstance beyond one party's reasonable control, including without limitation obstacle, failure or delay of transportation; fire; riot; war and abidance to any government law or regulation, affects directly or indirectly the party's ability to implement the contract, no party of the contract shall be responsible for the delayed implementation and failure of implementation.
- 13.2 If any party of the Contract cannot carry out any obligation under the Contract due to occurrence of force majeure, the party shall notify other party without delay and deal with the consequences rising from force majeure with other party on the basis of honesty and trust.

Section 3

Letter of Tender

**FLOOR SCREED AT THE CHAGUANAS FARMERS' MARKET –
WOODFORD LODGE, CHAGUANAS
LETTER OF TENDER**

The Secretary,
Tenders Committee,
The National Agricultural Marketing and
Development Corporation (NAMDEVCO)
S.S. Erin Road, Debe, Trinidad.

Dear Sir,

**RE: FLOOR SCREED AT THE CHAGUANAS FARMERS' AT WOODFORD LODGE
CHAGUANAS**

1. I / We have examined the Contract governing the performance of the Works including the Agreement, the Conditions of Contract, the Scope of Works, the Drawings, the Bills of Quantities and all other Documents in connection with this Tender, visited and inspected the Site and have made due allowance for Addenda Nos*
_____.

2. I / We have examined, understood and checked these requirements and have ascertained that they contain no errors or defects in these documents, and therefore have taken no exceptions and/or have qualify this offer to the Employer to perform the Works. I / We agree that the Contract Price is to strictly comply with the unmodified terms and conditions of the Contract herein and undertake for this Contract Price:
 - a) To execute and complete the Works described or referred to in the Drawings, Specifications, Bills of Quantities and other Schedules, in accordance with the Conditions of Contract as supplied to us;
 - b) To begin the work as such time as may be reasonably required but not less than seven (7) calendar days from the date of the written acceptance of this tender or from receipt of such working drawings and particulars as are agreed by us being sufficient for a start to be made, whichever is the later;
 - c) The Time for Completion in Calendar Days for the whole of the Works, is *_____ Days inclusive of Saturdays, Sundays and Public Holidays (Calendar Days);
 - d) To make good at our own cost any defects, shrinkages or other faults which shall appear within the Period for notifying defects, and which shall be due to materials or workmanship not in accordance with the Employer's Requirements and to pay any cost incurred arising from the making good of such defects, shrinkages or other faults.for the Vat Exclusive Sum of:

(words)

(words)
(\$ _____) Trinidad & Tobago Dollars

Plus Vat of

(words)

(words)
(\$ _____) Trinidad & Tobago Dollars

** To be stated*

**FLOOR SCREED AT THE CHAGUANAS FARMERS' MARKET –
WOODFORD LODGE, CHAGUANAS
LETTER OF TENDER**

**RE: FLOOR SCREED AT THE CHAGUANAS FARMERS' AT WOODFORD LODGE
CHAGUANAS**

3. I/We agree that this offer shall remain valid and to acceptance by you open until the expiration of 90 days from the date of this tender.
4. I/We agree that the Provisional Sums indicated shall be expended for contingencies as directed, instructed, or deducted in whole or in part by the sole discretion of the Employer if not required, without any entitlement to compensation by the Contractor to these sums.
5. I/We understand that the Employer is not bound to accept the lowest or any Tender for these Works.

Signed _____
(Signature)

Name _____
(Block Capitals)

in the capacity of

duly authorized to sign tenders for and on behalf of _____

(Name of Company)

(Address)

(Address)

Date _____

Company Stamp: _____

Section 4
Specifications

**FLOOR SCREED AT THE CHAGUANAS FARMERS' MARKET –
WOODFORD LODGE, CHAGUANAS
SPECIFICATIONS**

GENERAL

1.00 Obligations Imposed by the Engineer

- A. The market shall remain open during the Works and the Contractor must schedule his activities to account for same.
- B. The sale of food takes place on the site therefore the Contractor is always obligated to maintain a clean and sanitary site including all necessary disinfection of sensitive areas and dust control. All work areas shall be sanitized, washed down and cleaned after each day's work activity in a manner acceptable to the Employer's Representative.
- C. The Bill of Quantities is to be used for pricing the Works and submitting a Tender as per the Letter of Tender. The Quantities are generally measured in accordance with the Standard Method of Measurement (5th Edition Metric) unless otherwise described. Notwithstanding this, the Contractor is required to include in his price for complete execution of the Works as defined by the Specification and the drawings that may not be measured in strict accordance with the Standard Method of Measurement.
- D. Where lump sum prices are included in the Bill of Quantities, the Contractor shall submit a breakdown of this lump sum amount within seven (7) days of the Engineer's request. The Engineer reserves the right to withhold certification of lump sum amounts until the Final Certificate for failure to submit the breakdown of any lump sum amount requested within seven (7) days.

2.00 Definitions

- A. Where the term Engineer is used in this Section it shall mean the Employer's Representative in accordance with the Contract.
- B. Where Provisional Sums are given, the Contractor will be deemed to have made due allowance in programming, planning and pricing Preliminaries. Any such allowance will only be subject to adjustment in those circumstances where a variation in respect of other work measured in detail in accordance with the rules would give rise to adjustment.

3.00 Conflict

- A. All sections of the Tender Package are to be interpreted as one document; any conflict must be immediately brought to the attention of the Engineer for clarification. For the purpose of Pricing, where conflict may arise the priority of documents is as follows:
 - i. the Specification
 - ii. the Design Drawings
 - iii. the Bills of Quantities.

4.00 Pricing

- A. Allow in pricing for all incidental work directly associated with the items of Works which, at the time of tendering could reasonably have been foreseen. Prices shall be deemed to include for making good of all other work disturbed in the execution of the work described in this section with materials and workmanship to match in every respect the surrounding work and properly bonded thereto unless otherwise described.

**FLOOR SCREED AT THE CHAGUANAS FARMERS' MARKET –
WOODFORD LODGE, CHAGUANAS
SPECIFICATIONS**

B. Considerations

Pricing shall include for all considerations arising from the Specifications and reasonably inferred from the site conditions.

C. Departure from the Standard Method of Measurement

The Bill of Quantities is generally measured in accordance with the Standard Method of Measurement (5th Edition Metric). The Contractor shall allow in his rates, lump sum prices of otherwise in the Bill of Quantities for making good work disturbed, construction joints, bonding new to existing works, disposal of waste and spoil, all necessary labours (including but not limited to splayed cutting, curved cutting, raking cutting, mitred edges, short lengths, narrow widths, etc), guaranties, warranties and testing.

D. Prices shall include all considerations arising out of the specifications whether or not expressly itemized in the Bill of Quantities. No claim shall be brought against the Engineer for failure to include any consideration of this section in the Contract Price.

E. Works not covered by the Bills of Quantities but included in the Specifications and the Drawings and reasonably obvious from the site inspection shall be deemed included in the Contract Price.

F. All rates and prices of the work items are “fixed rate items” and shall not be adjusted for change in quantity.

**FLOOR SCREED AT THE CHAGUANAS FARMERS' MARKET –
WOODFORD LODGE, CHAGUANAS
SPECIFICATIONS**

CONCRETEWORK

1.00 Scope of Work

- A. This work includes the supply of all labour, materials, equipment and services necessary to complete all concrete work as shown or implied on the Engineer's drawing and / or Bills of Quantities and shall include the following:
 - i. Plain or mass concrete
 - ii. Reinforced concrete

2.00 Responsibility

- A. No approval or acceptance by the Engineer or his representative shall in any way relieve the Contractor of his responsibility for the quality of materials and the standard of workmanship in the finished works, and for the strength, durability and appearance of the finished concrete works.
- B. Supervision
All work is to be supervised by a foreman experienced in concrete construction.

3.00 Cement

- A. Cement used in the work is to be normal setting Portland Cement complying with British Standard No. 12 Part 2 or ASTM C 150.
- B. All cement shall be delivered in the original sealed containers of the manufacturer. No re-bagged cement will be permitted to be brought on to the site.
- C. On no account shall a change in the type or source of supply be permitted during the course of construction and every endeavour shall be made to ensure that the colour of the cement is constant throughout the contract.

4.00 Aggregate

- A. All aggregate shall be in accordance with B.S. 882. Coarse aggregate shall be of the minimum size specified in the drawings graded down to 5mm. Fine aggregate shall be coarse, sharp, well graded sand. All aggregate shall be clean and free from impurities. If and when considered necessary, all aggregates shall be site washed to the Engineer's satisfaction without extra charge.
- B. Samples of aggregate are to be submitted to the Engineer for approval at the commencement of the work.
- C. Once the site sample has been approved, the Contractor shall make arrangements with his aggregate supplier to establish that ample supplies of both coarse and fine aggregate of the quality and colour selected are available to complete the contract.
- D. After the approval of samples of the aggregates by the Engineer, the samples will be retained by them for comparison with all subsequent deliveries. Any delivery which in the opinion of the Engineer is not in accordance with the standard of the samples previously supplied by the Contractor shall be rejected as unfit for use in the works and shall forthwith be removed from the site by the contractor at his own expense.
- E. If the Engineer considers it necessary to carry out grading tests on the aggregate, the contractor shall be responsible for the cost of such tests.

**FLOOR SCREED AT THE CHAGUANAS FARMERS' MARKET –
WOODFORD LODGE, CHAGUANAS
SPECIFICATIONS**

5.00 Water

- A. The water used in the concrete is to be clean, drinkable, free from impurities and from a source approved by the Engineer.

6.00 Mix proportions

- A. Mix proportions shall be designed by the Contractor for each structural concrete mix specified.
- B. The mixes shall be designed to have sufficient workability to allow concrete to be placed and properly compacted by the methods to be used on site.

7.00 Site Control

- A. Irrespective of concrete grades, the quantities of cement and aggregates in the mix shall be measured separately by weight with approved weigh-batching plant.
- B. Where the cement is delivered to the site in bags, each batch of mixed concrete shall be proportioned to use an integral number of complete bags.
- C. The water-cement ratio determined in the calculation of proportions for each mix shall be accurately maintained. The amount of water used in each batch shall be controlled by direct measurement, and due allowance shall be made for water content of the aggregate.
- D. The slump test or compaction factor test shall be used as a guide to the workability of the mixed concrete.
- E. The permissible range of slump is 100mm maximum and 25mm minimum. Variations will be permitted on acceptance by the Engineer of the Contractor's proposals for concrete mix placement.
- F. If a change in the grading of any aggregate is unavoidable, the proportions of all structural concrete mixes affected shall be revised to take account of the altered grading.

8.00 Storage

- A. On arrival on the site, cement is at once to be stored in a dry shed with a raised floor and water-proof walls and roof, the cement is to be stored so that consignments are used in the order in which they are received.
- B. Cement which has become damp or which has deteriorated is not to be used and must be removed from the site.
- C. The fine and coarse aggregates shall be stored at the site on a hard-impervious surface such as a bed of weak concrete or a timber or sheet metal platform laid to a fall and in such a manner as to ensure protection from all extraneous matter.

**FLOOR SCREED AT THE CHAGUANAS FARMERS' MARKET –
WOODFORD LODGE, CHAGUANAS
SPECIFICATIONS**

9.00 Batching

- A. Aggregates shall be measured by WEIGHT. Cement shall be measured by weight using one or more complete bags to a batch.
- B. The quantity of water used in mixing the concrete shall be the minimum necessary to produce a workable mix. Due account shall be taken of the water content of the aggregates, especially following heavy rain.
- C. Mixing of the concrete shall be done in an approved mechanical mixer until there is a uniform distribution of materials and the mass is uniform in colour and consistency, but in no case shall the mixing continue for less than 2 minutes.

10.00 Mixing plant

- A. Weight batching plant shall be checked weekly in the presence of the Engineer. The checking shall be carried out with approved weights provided by the Contractor for this purpose.
- B. The water gauge of the concrete mixer shall be inspected and tested regularly when concreting is in progress.
- C. If any fault in the mixing plant is detected by these tests or otherwise, the fault shall be rectified to the satisfaction of the Engineer's representative before any further use is made of the equipment.

11.00 Pouring

- A. Concrete shall be handled so to avoid segregation, pollution, or loss of the ingredient and shall be placed in less than 30 minutes from the time of adding the water to the mix, and not subsequently disturbed.
- B. Concrete shall not be deposited through a chute, dropped through a height greater than 2 metres or deposited through water, without special permission of the Engineer.

12.00 Wet weather concreting

- A. Concreting during periods of constant rain shall not be permitted unless aggregate stockpiles, mixers and transporting equipment and the areas to be concreted are adequately covered.
- B. During showery weather, the Contractor shall ensure that work can be concluded at short notice by the provision of stop ends. On no account shall work be terminated before each section between one stop end and another is complete.
- C. Adequate covering shall be provided to protect newly placed concrete from the rain.

13.00 Compaction

- A. All concrete shall be vibrated with heavy duty high frequency poker vibrators and be additionally tamped and rammed so as to thoroughly fill the shuttering and form a dense homogeneous mass.

**FLOOR SCREED AT THE CHAGUANAS FARMERS' MARKET –
WOODFORD LODGE, CHAGUANAS
SPECIFICATIONS**

14.00 Curing

- A. Concrete, after being placed, shall be protected from the effect of sunshine and rain. Concrete is to be kept moist by well watering for at least 3 days after placing and exposed surface are to be covered with hessian or other approved material to effectively retain the water.
- B. Proprietary curing compounds may be used with the permission of the Engineer.

15.00 Construction joints

- A. Positions of construction joints where not shown on the drawings are to be approved by the Engineer.
- B. All construction joints details are to be designed by the Contractor and approved by the Engineer before construction. They shall be hacked to remove all laitance or loose material and thoroughly washed down.

16.00 Blinding

- A. 50mm layer of blinding concrete (1:4:8) mix shall be placed under all reinforced concrete built on the ground.

17.00 Finish

- A. The surface of all concrete slabs is to be floated to a uniform smooth surface unless otherwise specified on the drawings.
- B. Concrete floor slabs shall be cast in panels of 40 sq. m. maximum an interval of 48 hours being left between casting adjacent panels.

18.00 Ready-mixed concrete

- A. Ready-mixed concrete shall be permitted provided the following additional requirements are complied with:
 - i. No water shall be added to the aggregate and cement in the mixer until instructions to do so are given by the Foreman on Site.
 - ii. Discharge of concrete shall be completed within 1/2 hour of adding the mixing water to the cement and aggregates.
 - iii. The Contractor shall obtain certificates showing batch records of the quantities by weight of all the solid materials, of the total amount of water used in mixing and of the results of all tests. He shall produce these certificates for the Engineer as requested.
 - iv. A minimum of six site test cubes per 40 cubic metres of concrete delivered shall be made and tested in accordance with B.S. 1881 if so required by the Engineer and at the Contractor's own expense.
 - v. In all other respects, the ready-mix concrete shall comply with the requirements of the previous clauses for concrete.

**FLOOR SCREED AT THE CHAGUANAS FARMERS' MARKET –
WOODFORD LODGE, CHAGUANAS
SPECIFICATIONS**

19.00 Reinforcement

- A. The steel reinforcement shall be grade 410 high yield steel bars to TTS 16 35 500 or TTS 16 35 501.
- B. Reinforcement described as "mesh" reinforcement is welded steel fabric complying with B.S. 4483. Attention is to be paid, in the placing of such mesh reinforcement, to the direction of the main bars as shown on the drawings. All mesh shall be purchased from the manufacturers as flat sheets.
- C. All reinforcement shall be thoroughly cleaned and free from scale. Reinforcement shall be wire brushed if required by the Engineer.
- D. All reinforcing steel is to be bent cold to the dimensions given on the bar schedules. Bar dimensions are given according to B.S. 4466, i.e., the dimensions of links are inside dimensions, otherwise dimensions given are outside dimensions.
- E. Reinforcement is to be fixed firmly in position before concreting and the Contractor is to allow in his rates for all additional reinforcement, chairs, spacers or other items necessary to achieve this.
- F. Binding wire is to be arranged with the ends bent away from the shuttering so that the concrete cover is not reduced by more than the diameter of the wire.
- G. A lap of not less than forty-four diameters of the smaller bar shall be provided at the junction of two bars for which the lap is not specifically detailed on the drawings.
- H. All reinforcement shall be accurately placed, securely fixed and adequately maintained in the positions shown on the drawings and the Contractor shall allow in his price for all additional reinforcement, spacer bars and other items necessary to achieve this.
- I. The concrete cover to the reinforcement detailed on the drawings shall be maintained by use of approved methods.
- J. The placing and fixing of all reinforcement between successive construction joints shall be completed, inspected and approved by the Engineer before the concreting of that section of structure begins. The Contractor shall give the Engineer 48-hours' notice of the times for these inspections.
- K. Welding of steel reinforcement is not required. No welding of reinforcement shall be put in hand without the written permission of the Engineer.
- L. No metal part of any device used for connection bars or for maintaining reinforcement in the correct position shall remain permanently within the specified minimum concrete cover to the reinforcement.

**FLOOR SCREED AT THE CHAGUANAS FARMERS' MARKET –
WOODFORD LODGE, CHAGUANAS
SPECIFICATIONS**

21.00 Formwork

- A. Formwork and its supporting members shall be sufficiently strong to carry the works and all incidental loading. The props and lateral supports shall be sufficiently closely spaced to prevent displacement or visible deflection of the shutters under the weight or hydraulic pressure of the wet concrete. All joints in the formwork and joints between the formwork and previous work shall be sufficiently tight to prevent loss of liquid from the concrete through these joints.
- B. Fixing blocks, ends of brackets, bars, bolts etc., shall be cast in the concrete at the time of placing and all mortices, holes, apertures, chases, grooves, etc., shall be accurately set out in the formwork as the concrete is placed. No part of the concrete works shall be cut away for any such item, or for any other reason, without the Engineer's and/or Engineer's permission.
- C. The Contractor shall obtain from all sub-contractors, complete information of their requirements regarding conduits, pipes, fixing blocks or boxes, chases, holes and any other items to be cast or formed in the concrete members, subject to the condition that failure of a subcontractor to supply such information shall not be allowed to delay the progress of the Contract.
- D. The Contractor shall ensure that all subcontractors are informed of his programme for the structural works at the commencement of the Contract. He shall also ensure that subcontractor's requirements relating to concrete members are approved by the Engineer and Engineer before work is commenced.
- E. At the commencement of the Contract, the Contractor shall supply all subcontractors with written copies of this section of the specification.
- F. The vertical propping to all formwork shall be carried down sufficiently far to provide the necessary support without damages overstress or displacement of any part of the construction.
- G. Structural props shall be retained in position until new construction is sufficiently strong to support its own weight and any loads to be placed on it during the Contract period.
- H. The internal faces of the formwork may be coated with an approved preparation to prevent adhesion of the concrete to the forms, provided that this preparation shall not be allowed to touch the reinforcement.
- I. Immediately before the concrete is placed in any section of the formwork, the interior of that section shall be completely cleared of all extraneous materials.
- J. Each section of the formwork to structural members shall be inspected and passed by the Engineer's representative immediately before the concrete is placed in that section.
- K. The structure shall not be distorted, damaged or overloaded in any way by the removal of the formwork from concrete members.
- L. The responsibility for the safe removal of any part of the formwork or strutting shall rest with the Contractor.
- M. Before the formwork is removed from any structural member, the Contractor shall ensure that the concrete in the member has attained sufficient strength for striking to proceed.

**FLOOR SCREED AT THE CHAGUANAS FARMERS' MARKET –
WOODFORD LODGE, CHAGUANAS
SPECIFICATIONS**

22.00 Exposed concrete finishes

- A. Where exposed concrete finishes are required, the Contractor shall provide in a suitable position, test samples of each type of finish to be used in the works. The test samples shall be approved by the Engineer before these finishes are put in hand in the works.
- B. The test pieces shall be vertical panels, 1 metre square and 225mm thick. After approval, they shall be retained in position until the concrete works have been completed when they shall be demolished and removed from the Works.
- C. The approved sample panel will be deemed to represent the minimum acceptable standard in the work.

23.00 Fair faced exposed concrete faces

- A. Unless otherwise specified all concrete faces to be exposed in the finished works shall be left as struck with a fair face, true to line, and level within the specified tolerances for the works. Use properly braced plywood shuttering on all surfaces described as "fair faced" which will remain exposed in the finished works.
- B. After inspection all superfluous fins and similar projections shall be carefully removed. No render or other applied finish shall be used to obtain a fair face to the concrete.
- C. All concrete faces to be exposed in the finished works shall be adequately protected against damage and surface staining during the execution of subsequent works.
- D. Any finished works which the Engineer shall judge inferior in any respect to the standard of the relevant approved sample or which is subjected to subsequent damage or surface staining shall be rejected and treated as defective work.

**FLOOR SCREED AT THE CHAGUANAS FARMERS' MARKET –
WOODFORD LODGE, CHAGUANAS
SPECIFICATIONS**

FINISHINGS

1.00 Screeds

A. Screeds to be composed of cement and sand 1:4. Surfaces of site slab shall be thoroughly brushed clean of all foreign matter and well soaked prior to laying of screeds together with the use of an appropriate bonding agent in accordance with the manufacturer's instructions. Minimum thickness of screed shall be 25mm; otherwise, an approved bonding / reinforcing additive is to be utilized in the mixture in strict accordance with the manufacturer's instructions.

B. Levels Generally

Ensure that the levels of the floor within one area and between adjoining areas are constant unless specifically described or shown to be otherwise.

Finished floor level is taken as Top of floor finish. Make up for any variations in the thickness of precast or pre-moulded floor finishings and irregularities in the surface of the structural base by adjusting the thickness of the screed as necessary.

C. Preparation of Surfaces

Surfaces to be screeded must be brushed clean and well wetted before screed is laid.

D. Fresh Mixes

Partially or wholly set material will not be allowed to be reused or remixed

E. In-situ finished generally

All screeds and pavings shall be finished smooth, even and timely level and shall be steel troweled or floated internally to receive carpet or carpet tiles.

F. The mortar mix used in the screed shall be 1:3 cement:sand. Mix to be proportioned to ensure adequate finishability.

G. Castings shall be in bay not exceeding 3.0 metres x 3.0 metres Flatness / Surface regularity. Sudden irregularities are not permitted. The contractor must attempt to archive the high standard of 3mm of deviation of surface as measured from the underside of a 3 metre long straightedge (between points of contract) placed anywhere on the surface. The normal standard of surface deviation is 5mm which is the maximum permissible deviation.

H. Wet all in-situ floor finishings and keep damp for at least 7 days after laying by thickly covering with hessian or polythene membrane keep moist by frequent sprinkling with water.

5.00 Walls

A. Rendering

- Mix rendering composed of one-part cement and five parts sand with a plasticizer additive at the rate of .14 litre of plasticizer to every bag of cement.
- Proportion materials by measure and not by estimation and proper approved measuring boxes must be provided for this purpose. Make up mix on site in a close boarded wood platform with upstand edges and thrice turn over mix while water is being added through a rose director and use immediately thereafter.
- Where approved mechanical batch mixers are employed rotate each batch in the drum at least two minutes and use immediately thereafter.

**FLOOR SCREED AT THE CHAGUANAS FARMERS' MARKET –
WOODFORD LODGE, CHAGUANAS
SPECIFICATIONS**

- Thoroughly wash out all platforms and mixers at the cessation of work each day and as necessary during the working hours.
- Mix only quantities which can be used at once and reject rendering which has begun to set before being required.
- Carefully float all work and finish to a minimum thickness of 12mm with surfaces perfectly flat to stand the straight edge every way, free from all cracks and leave perfectly clean.
- "Throw" all rendering and plaster on the wall and give the minimum of "working" to ensure a plumb and even finish.
- Wherever possible complete each section of walling in one operation, but where this is not possible the existing edge shall be well hacked and wetted before recommencing operations. Throughout the whole of the Works order sufficient sand to prevent any discrepancy between the quality and colour of different rendering.
- Allow for preparing and wetting all surfaces prior to commencement of all operations, for any additional thickness required in dubbing out and for working around and behind pipes with their connections and fixtures.

Section 5

Preliminaries

FLOOR SCREED AT THE CHAGUANAS FARMERS' MARKET –

WOODFORD LODGE, CHAGUANAS

PRELIMINARIES

Item	Description	Qty	Unit	Rate	\$	¢
	<p>GENERAL INFORMATION</p> <p>Read the Specifications, the Preliminaries and the Measured Works Sections as one document. The Contractor is to include in his rates and prices of the Measured Work for all items of the Preliminaries Section OR alternatively include lump sum prices as set out in the following pages.</p> <p>NAMES OF PARTIES</p> <p>The titles and terms used in connection with this project shall have the following meaning:-</p> <p>A Employer: The National Agricultural Marketing and Development Corporation (NAMDEVCO) S.S. Erin Road, Debe, Trinidad. Tel: (868) 647-3218 / Fax: (868) 647-6087</p> <p>B Employer's Representative: TBD</p> <p>DESCRIPTION OF WORKS</p> <p>D The works involve the construction of a screeded bed at the warehouse building of the Chaguanas Farmers' Market, Woodford Lodge, Chaguanas.</p> <p>LOCATION OF SITE</p> <p>E The site of the proposed works is at the Chaguanas Farmers' Market, Woodford Lodge, Chaguanas.</p> <p>F The Contractor will be given conditional access to the site for the purposes of carrying out the Works but is to be cognizant that the Employer will be present on site in the course of executing his duties.</p> <p style="text-align: right;"><i>carried forward</i></p>		<p>Item</p> <p>Item</p> <p>Item</p> <p>Item</p>			

FLOOR SCREED AT THE CHAGUANAS FARMERS' MARKET –

WOODFORD LODGE, CHAGUANAS

PRELIMINARIES

Item	Description	Qty	Unit	Rate	\$	¢
	<i>brought forward</i>					
	CONTRACT PARTICULARS					
A	The Conditions of Contract, shall be that as detailed as detailed in Section 2. The price shall be deemed to cover all the implications contained therein and set out below.		Item			
B	The Clause numbers and headings for the Conditions are NOT individually itemized; the Contractor is to price for ALL consideration arising from the Conditions of Contract.		Item			
C	No claim shall be brought against the Employer for failure to adequately include in the rates and prices of the measured work section for any consideration arising from the Conditions set out in Section 2.		Item			
D	The Scope of Works is listed in Section 4; the price shall be deemed to cover all the implications contained therein and set out below. No claim shall be brought against the Employer for failure to adequately include for any consideration arising from the Scope of Works.		Item			
	OBLIGATIONS IMPOSED BY EMPLOYER					
E	All existing roads, pavings, services drains, sewers etc. serving the site must be protected and maintained during the contract period unless their removal is required as a result of the new work. In this case approved temporary measures must be taken to maintain all services. All precautions must be taken to avoid damage to areas of the Building outside of the Construction site and any damage incurred shall be made good at no cost to the Employer.		Item			
F	The market shall remain open during the Works and the Contractor must schedule his activities to account for same. No work shall be allowed on Thursdays		Item			
	<i>carried forward</i>					

FLOOR SCREED AT THE CHAGUANAS FARMERS' MARKET –

WOODFORD LODGE, CHAGUANAS

PRELIMINARIES

Item	Description	Qty	Unit	Rate	\$	¢
	<i>brought forward</i>					
	OBLIGATIONS IMPOSED BY EMPLOYER					
A	The sale of food takes place on the site therefore the Contractor is always obligated to maintain a clean and sanitary site including all necessary disinfection of sensitive areas and dust control. All work areas shall be sanitized, washed down and cleaned after each day's work activity in a manner acceptable to the Employer's Representative		Item			
B	The Contractor is to allow for working alongside and in tandem with other Employer, his Agents, other Contractors and Occupants of the Building.		Item			
	PRICING					
C	The prices inserted shall be deemed to include for the payment of all customs, duties, taxes and the like, for the provision of all labour, materials and plant, for transport, for deliveries to site (where not specifically mentioned in the description), for temporary storage of materials and return of empties, for the erection, maintenance and removal of scaffolding, temporary staging, plank ways, protection etc., and for all other things necessary for the completion of the Works in accordance with the documents forming the Contract.		Item			
D	The Bill of Quantities is generally priced in accordance with the Standard Method Measurement. The Contractor is to price each item in accordance with the details shown on the Drawings, described in the Bill of quantities and is to include all ancillary works required in executing each item of work.		Item			
	VALUE ADDED TAX					
E	Items are to be priced net of Value Added Tax, The Tenderer is to make his addition for Value Added Tax where indicated on the Summary page.		Item			
	<i>carried forward</i>					

FLOOR SCREED AT THE CHAGUANAS FARMERS' MARKET –

WOODFORD LODGE, CHAGUANAS

PRELIMINARIES

Item	Description	Qty	Unit	Rate	\$	¢
	<i>brought forward</i>					
	WORKFORCE					
A	Allow for all costs in respect of National Insurance, Vacation and Public Holiday Leave, Sick Leave, Cost of Living Allowances, subsistence allowances, traveling time and expenses and all other emoluments and expenses payable to or in connection with the employment of persons for the Works.		Item			
B	Comply with all local regulations in force relating to the welfare of work-people on the site or in places where work is being prepared for incorporation into the Works.		Item			
C	Overtime working may be considered necessary in order to complete the Works by the Contract completion date and the Contractor is to allow in his tender for any overtime work which he considers necessary to complete the works by that date. obtain the prior consent of the Employer's Representative for carrying out overtime work.		Item			
	SITE PARTICULARS					
D	Visit Site Visit the site and ascertain the nature of the work to be done, means of access and egress, the availability and positions of essential services, viz electricity water etc., condition of site, working space and storage for materials and allow in this tender for all such factors which may affect the execution of the Works. No claim shall be made for failure of the Contractor to visit the site and ascertain the site conditions.		Item			
	LOG BOOK					
R	Provide and keep on the site of the Works a suitable Log Book in which the Engineer may enter and confirm any verbal instructions given.		Item			
	<i>carried forward</i>					

FLOOR SCREED AT THE CHAGUANAS FARMERS' MARKET –

WOODFORD LODGE, CHAGUANAS

PRELIMINARIES

Item	Description	Qty	Unit	Rate	\$	¢
	<i>brought forward</i>					
	MATERIALS AND WORKMANSHIP					
A	Best quality Materials and workmanship are to be of the best quality of their respective kinds, and those for which there is a British Standard or Code of Practice are to conform thereto unless otherwise stated. Workmanship is to conform to sound building practice unless described or shown.		Item			
B	Defective Work Any defective materials or substandard workmanship not in accordance with this Contract shall be removed and replaced without charge.		Item			
	GOVERNMENT AND LOCAL ORDINANCES ETC.					
C	Allow for compliance with all Government and Local Ordinances, orders, rules and regulations in so far as is not provided for elsewhere in these Bills.		Item			
D	Allow for compliance with any regulations made by the Police for the temporary parking of vehicles and the loading and unloading of persons or goods.		Item			
	SITE COMMUNICATIONS					
E	The Contractor is to establish a communication system for effective communication to and from the site management and the Engineer.		Item			
	WATCHING AND PROTECTION					
F	Provide security to effectively protect the Works for which the Contractor is responsible and materials stored in the construction area including those of subcontractors and accept all risks for damage and loss.		Item			
	<i>carried forward</i>					

FLOOR SCREED AT THE CHAGUANAS FARMERS' MARKET –

WOODFORD LODGE, CHAGUANAS

PRELIMINARIES

Item	Description	Qty	Unit	Rate	\$ ¢
A	<p style="text-align: right;"><i>brought forward</i></p> <p>WATCHING AND PROTECTION</p> <p>Allow for any hoarding which may be required for the protection of the workpeople, occupants, adjoining property and the public and alter, adapt and maintain them as necessary and allow for removal of temporary hoarding upon completion.</p>		Item		
B	<p>PROVISIONAL SUMS</p> <p>The term "Provisional Sum" shall mean a sum provided for work or for costs which cannot be entirely foreseen, defined, or detailed at the time the tendering documents are prepared. Such sum shall be used in part or in whole as directed by the Engineer and shall be deemed to be inclusive of any profit required by the Contractor unless otherwise indicated. No claim for "loss of profit" shall be brought against the Employer from the non-expenditure of the entire or any part of a Provisional Sum.</p>		Item		
C	<p>The Provisional Sum shall also be used (solely on the Engineer's discretion) for works and services to be executed by a sub-contractor nominated by the Engineer. Such sums may be used in whole or in part as directed by the Engineer and shall be deemed to be exclusive of any profit required by the Contractor. No claim whatsoever shall be brought against the Employer for the execution of work under a Provisional Sum by a nominated sub-contractor, statutory body or the like.</p>		Item		
D	<p>PROTECTION OF WORKS</p> <p>Case up and protect all work including that executed by sub-contractors and specialists from any kind of injury and damage. Provide all necessary temporary roofs, tarpaulins, screens, plankings and general protection that may be required and clear away when no longer needed and reinstate any work which has become damaged or stained.</p>		Item		
	<p style="text-align: right;"><i>carried forward</i></p>				

FLOOR SCREED AT THE CHAGUANAS FARMERS' MARKET –

WOODFORD LODGE, CHAGUANAS

PRELIMINARIES

Item	Description	Qty	Unit	Rate	\$	¢
	<i>brought forward</i>					
	DOCUMENTS PROVIDED					
	One document					
A	Read the Specifications, Bills of Quantities and Drawings as one document and carry out everything for the proper execution of the Works whether or not specifically shown therein, provided the same may reasonably be inferred therefrom.		Item			
	Ordering of materials					
B	Use neither the Drawings nor the Schedules as a materials ordering list. Prepare own materials ordering list based on the construction drawings, specifications issued and on site measurements where appropriate.		Item			
	Definitions					
C	The terms "approved", "directed", or "selected" mean the approval, direction or selection of the Employer, unless otherwise described.		Item			
D	Wherever the term "allow" or the term "include" occurs in this document, except with reference to Provisional sums, the cost of the item is at the risk of the Contractor.		Item			
E	The term "Item" where used as a Unit for pricing in the Bills of Quantities affords the Contractor to include lump sum prices for the Work Item. The Employer may at his discretion request the Contractor to submit a breakdown of any lump sum price included in the Contract Documents.		Item			
	CLEAR AWAY AND CLEAN DOWN					
F	Clear away all plant and temporary work unless otherwise described or directed and make good. Clear away all existing rubbish, debris and surplus materials as they accumulate and at completion.		Item			
	<i>carried forward</i>					

Section 6

Measured Works

**FLOOR SCREED AT THE CHAGUANAS FARMERS' MARKET –
WOODFORD LODGE, CHAGUANAS
MEASURED WORKS**

Item	Description	Qty	Unit	Rate	\$	¢
	<p>GENERAL PREAMBLE</p> <p>Standard Method of Measurement</p> <p>The Works are generally measured in accordance with the Standard Method of Measurement 5th Edition Metric. Notwithstanding this, the Contractor is to include in his price for all considerations arising out of the descriptions in the Bills of Quantities, the details on the Drawings, the materials and workmanship described in the Scope of Works and ancillary works observed at the Site Visit.</p> <p>Evaluation</p> <p>All Items in this Section are deemed to be Provisional and subject to remeasure on completion.</p> <p>For each item of work, the rate or price for the item shall be the rate or price specified for such item on the Contract; all rates and prices in this section are specified as "fixed rate items". No adjustment in rate shall be considered due to change in quantity.</p> <p>Technical Specification</p> <p>The descriptions below are to be read in conjunction with the relevant Specification in Section 4.</p> <p>A The Contractor may include here for any items of the Specifications applicable to the Works and which may not have been included elsewhere.</p> <p>Design Drawings</p> <p>The descriptions below are to be read in conjunction with the relevant Design Drawings appended in Section 8.</p> <p>B The Contractor may include here for any items shown on the drawings or ascertained from the site visit but not specifically called out in the Bills of Quantities applicable to the Works and which may not have been priced elsewhere.</p> <p style="text-align: right;"><i>carried to summary</i></p>		Item			

FLOOR SCREED AT THE CHAGUANAS FARMERS' MARKET –

WOODFORD LODGE, CHAGUANAS

MEASURED WORKS

Item	Description	Qty	Unit	Rate	\$	¢
	SCREEDDED BED					
	Preparatory Work					
A	Scabbling existing floor surfaces to form key, jagged and roughen surfaces to ensure extensive bonding between existing concrete and screeding, make good to receive new works and dispose of all debris off site.	1500	m2			
	Reinforcement fabric; BS4443; plain round mild steel, welded and including all necessary tying wire, distance blocks and labours.					
B	Reference A142; 225mm side and end laps in slab (measured with no allowance for laps and bends)	1500	m2			
	In-situ Finish					
	Reinforced concrete (30N/mm² in 28 days) including "poly V 7" cement binder packed into formwork and around rod reinforcement (both measured separately)					
C	Screeded bed; average 112.5mm thick laid to falls and crossfalls as shown on Drawing S-09.	1500	m2			
D	B66 sealant to obtain a smooth dust free surface.	1500	m2			
	Formwork to					
E	Screeded bed; vertical sides not exceeding 175mm thick	203	m			
	Crack Control Joints					
F	Installation of crack control joints to be designed by Contractor and Approved by Engineer.		L.S.			
	Weep Holes (Perimeter Wall)					
G	Provide and install weep holes to perimeter wall to match existing, complete with insect/pest mesh protection, discharging into box drain.		L.S.			
	<i>carried to summary</i>					

Section 7

Summary

FLOOR SCREED AT THE CHAGUANAS FARMERS' MARKET –

WOODFORD LODGE, CHAGUANAS

SUMMARY

Item	Description	Unit	\$	¢
	PRELIMINARIES			
	Preliminaries brought forward from Page 5 / 8	Item		
	MEASURED WORKS			
	General Preamble brought forward from Page 6 / 1	Item		
	Screeded Bed brought forward from Page 6 / 2	Item		
	SUB-TOTAL	Item		
	CONTINGENCY SUM			
	Allow for Contingency Sum to be used as directed by Employer or deducted in whole or part if not expended.	10 %		
	TENDER AMOUNT <i>carried to Letter of Tender</i>	Item		
	Value Added Tax 12.5%	Item		
	TENDER AMOUNT (Vat Inclusive)	Item		

Section 8

Drawings

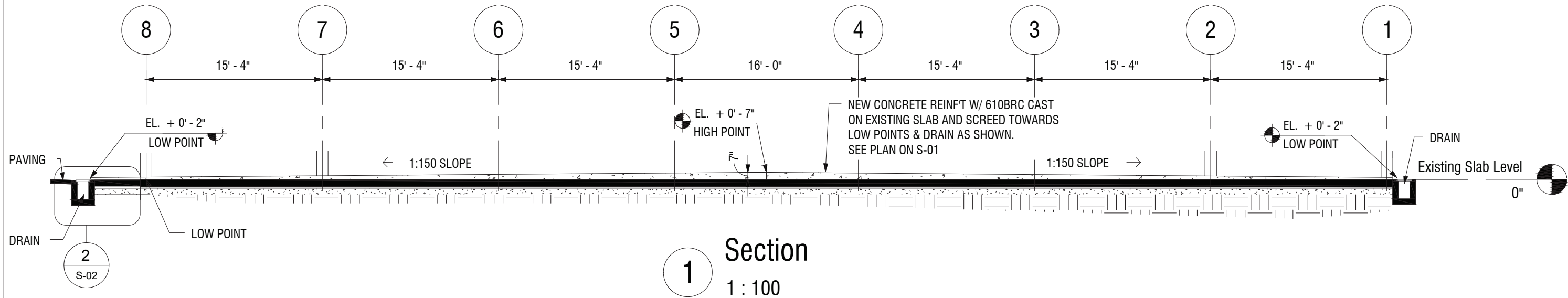

1 Section
1 : 100

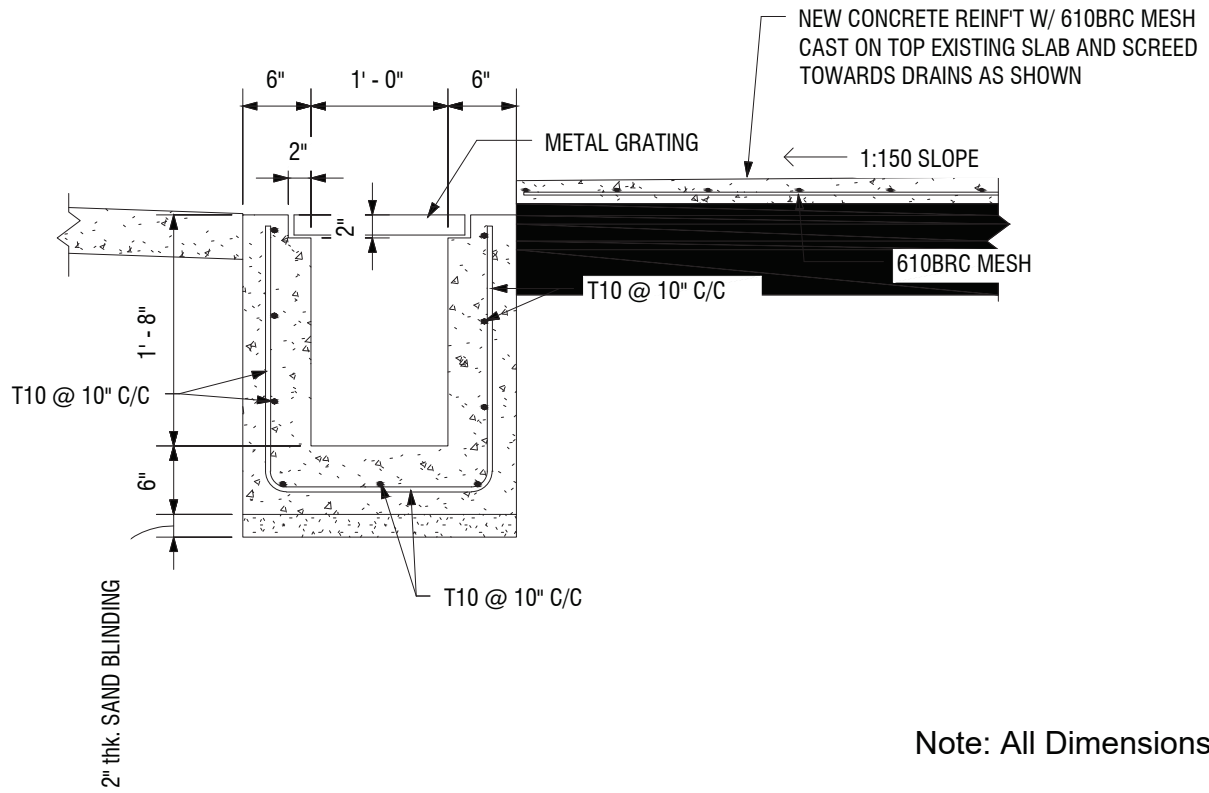

2 Detail
3/4" = 1'-0"

Note: All Dimensions to be verified on site.

FOR CONSTRUCTION

THIS DRAWING CONTAINS INFORMATION WHICH IS SUBJECT TO OBLIGATION OF CONFIDENTIALITY. IT'S CONTENTS SHALL NOT BE COPIED, DISCLOSED TO THIRD PARTIES, OR USED FOR OTHER THAN THE EXPRESSED PURPOSE FOR WHICH IT HAS BEEN PROVIDED WITHOUT WRITTEN CONSENT OF ALERON LIMITED (c) 2011. THIS DRAWING IS COPYRIGHTED AND REMAINS THE INTELLECTUAL PROPERTY OF ALERON LIMITED (c) 2011 AND SHALL BE USED FOR THIS SITE ONLY.

A	BI	RH	BI	06/05/2015
Revision	Designed	Drawn	Checked	Date

Client Name	NAMDEVCO
Client Address	S.S. ERIN ROAD , DEBE

Project Title	WOODFORD LODGE FACILITY
Drawing Title	PROPOSED BUILDING DRAINAGE - SECTION & DETAIL

Project No.	1428
Scale	AS SHOWN

 One Ten Architects & Planners Ltd.
 60 Arena Rd, Freeport.
 Tel: (868) 673-7551
 Email: one10architects@yahoo.com

ALERON
 CONSULTING ENGINEERS
 Aleron Limited Consulting Engineers
 89 Union Park East, Gopaul Lands, Marabella Trinidad, W.I.
 Mobile: (868) 374-6799, (868) 686-2835

SEAL

Sheet No.	S-09
Revision	A

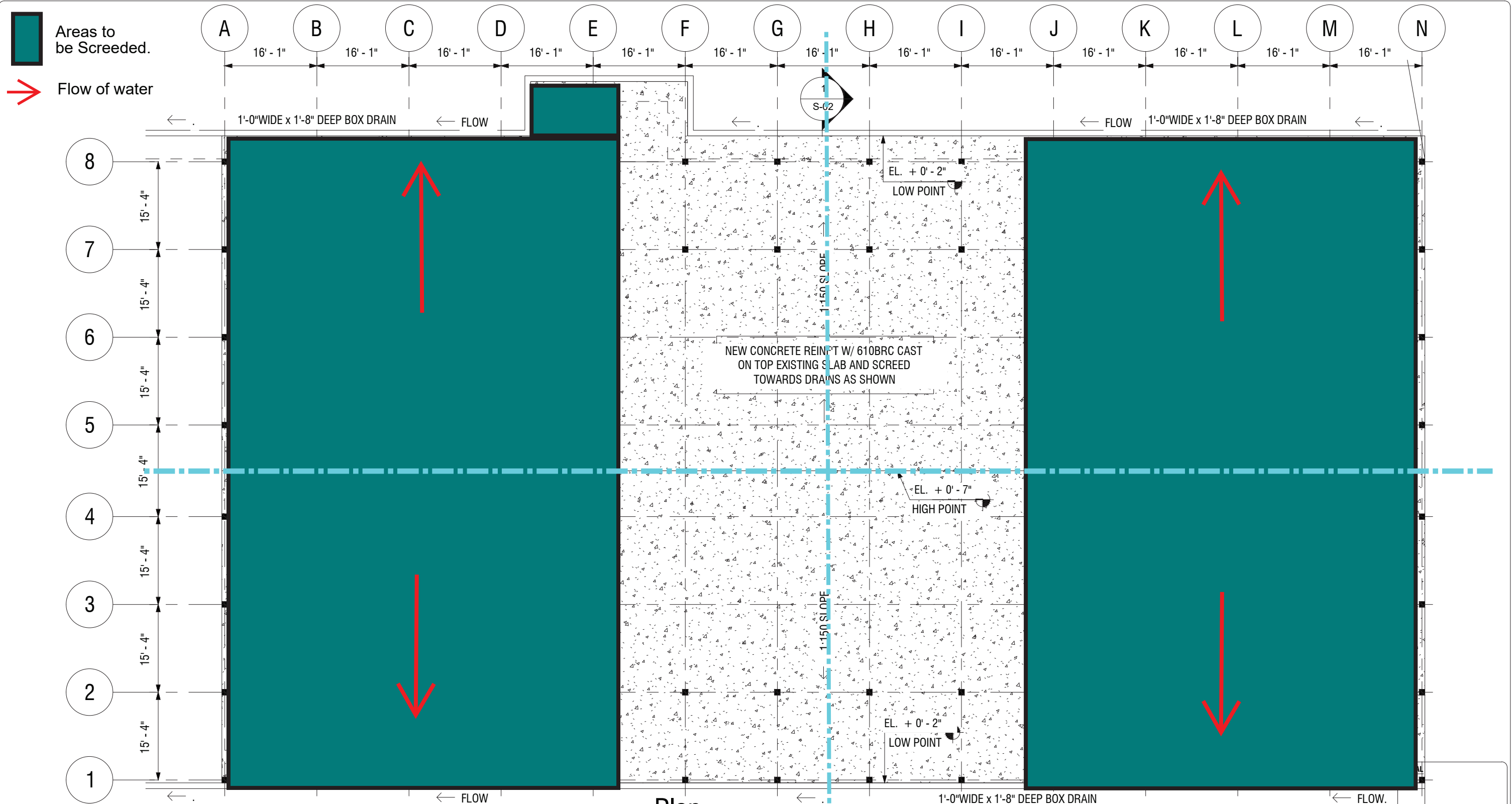

1 Plan
1/16" = 1'-0"

Note: All Dimensions to be verified on site.

FOR CONSTRUCTION

THIS DRAWING CONTAINS INFORMATION WHICH IS SUBJECT TO OBLIGATION OF CONFIDENTIALITY. ITS CONTENTS SHALL NOT BE COPIED, DISCLOSED TO THIRD PARTIES, OR USED FOR OTHER THAN THE EXPRESSED PURPOSE FOR WHICH IT HAS BEEN PROVIDED WITHOUT WRITTEN CONSENT OF ALERON LIMITED (c) 2011. THIS DRAWING IS COPYRIGHTED AND REMAINS THE INTELLECTUAL PROPERTY OF ALERON LIMITED (c) 2011 AND SHALL BE USED FOR THIS SITE ONLY.

A	BI	RH	BI	06/05/2015
Revision	Designed	Drawn	Checked	Date

Client Name	NAMDEVCO
Client Address	S.S. ERIN ROAD , DEBE

Project Title	WOODFORD LODGE FACILITY
Drawing Title	PROPOSED BUILDING DRAINAGE - PLAN

Project No.	1428
Scale	AS SHOWN

One Ten Architects & Planners Ltd.
60 Arena Rd, Freeport.
Tel: (868) 673-7551
Email: one10architects@yahoo.com

ALERON
CONSULTING ENGINEERS
Aleron Limited Consulting Engineers
89 Union Park East, Gopaul Lands, Marabella Trinidad, W.I.
Mobile: (868) 374-6799, (868) 686-2835

Sheet No.	S-08
Revision	A